

Ground Floor

Approx. 43.7 sq. metres (470.2 sq. feet)

KEY

- FD - Fire Door
- TT - Thumb Turn Lock
- EL - Emergency Light
- SD - Smoke Detector
- HD - Heat Detector
- COD - Carbon Monoxide Detector
- B - Boiler



Total area: approx. 87.6 sq. metres (943.1 sq. feet)

Whilst every attempt has been made to ensure the accuracy of the floor plan contained here, measurements of doors, windows, rooms and any other items are approximate and no responsibility is taken for any error, omission, or mis-statement. The Plan is for illustrative purposes only. Version 1

Plan produced using PlanUp.

1 Langton Close

First Floor

Approx. 43.9 sq. metres (472.9 sq. feet)

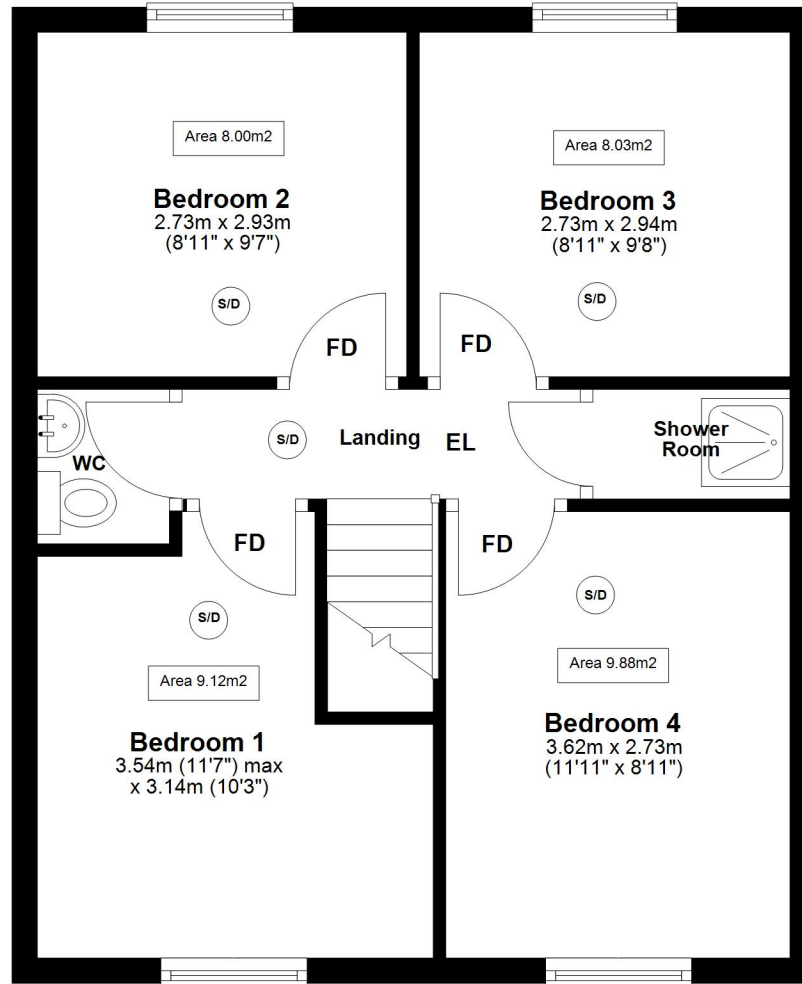

Ground Floor

Approx. 43.7 sq. metres (470.2 sq. feet)



First Floor

Approx. 43.9 sq. metres (472.9 sq. feet)

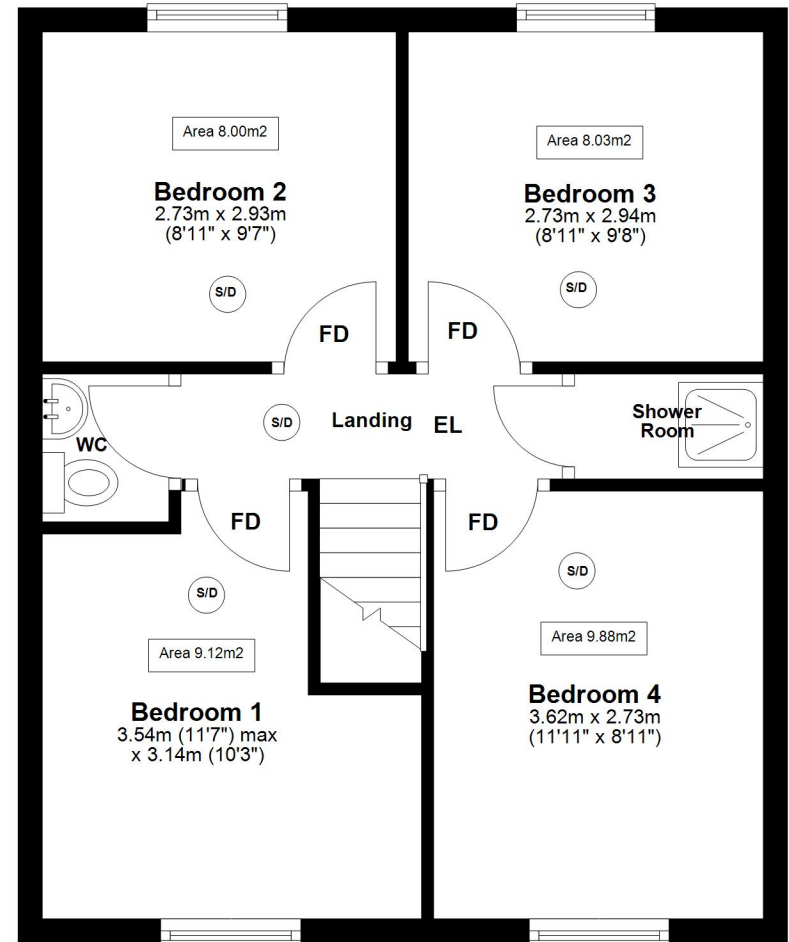

Total area: approx. 87.6 sq. metres (943.1 sq. feet)

Whilst every attempt has been made to ensure the accuracy of the floor plan contained here, measurements of doors, windows, rooms and any other items are approximate and no responsibility is taken for any error, omission, or mis-statement. The Plan is for illustrative purposes only. Version 1

Plan produced using PlanUp.

1 Langton Close